

SRG LPG High Pressure Compact Regulator Type 555

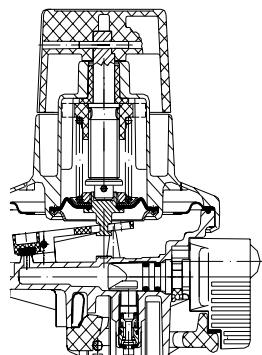

Compact

Inlet Connections	Outlet Connections
<ul style="list-style-type: none"> ♦ 20 mm to EN 12864, fig. G.52 ♦ 21 mm to EN 12864, fig. G.53 ♦ 22 mm to EN 12864, fig. G.54 	<ul style="list-style-type: none"> ♦ 3/8 BSP - LH ♦ W 21.8 x 1.814 - LH, to EN 12864, fig. G.4 ♦ W 22 x 1/22 - LH, to EN 12864, fig. G.6 ♦ Nozzle 8, for hose with 8 mm inner dia., to EN 12864, fig. H.50 ♦ Nozzle 10, for hose with 10 mm inner dia., to EN 12864, fig. H.51 ♦ other outlet connections available on request
Outlet Pressure	Color
0-2 bar	<ul style="list-style-type: none"> ♦ blue grey ♦ other colors available on request

Product Description:

The SRG Adjustable High Pressure Compact Regulator in connection with the SRG cylinder valve reduces the high gas pressure in the cylinder to the outlet pressure from **0-2 bar** which is required for the operation of torches, burners and furnaces for commercial and industrial applications. (Single stage regulation with reinforced diaphragm)

The body and cover of this regulator form a sealed unit after assembly in order to prevent any external interference which may affect the regulating mechanism.

Regulator inlet with additional shut-off valve for extra safety.

No tools are required to connect the regulator to the valve.

Materials and Standards:

The SRG Adjustable High Pressure Compact Regulator is made of a zinc die casting (body and cover) and other corrosion-resistant and LPG-proof materials such as brass, stainless steel and acetal resin. The rubber materials used are developed and produced according to the requirements of **EN 549** as well as in accordance with SRG's own stringent specifications.

Quality standards:

SRG's quality-control system carries an **ISO 9001** certificate and is continually assessed by the Notified Body

Capacity:

Rated for inlet pressure of between 2,5 and 16 bar the regulator has a capacity of 8,0 kg gas/hr.

Operation:

Connection lever and on/off tap interlocked to ensure easy and safe handling:

- Connection is simple, by just pressing down
- Cannot be unintentionally disconnected.
- Switching on is possible only when the regulator is connected properly with the cylinder valve

The delivery pressure can be adjusted between 0 and 2 bar by turning the control knob anti-clockwise for increasing the pressure, respectively clockwise for reducing the pressure.

Packaging:

The SRG Adjustable High Pressure Compact Regulator comes packed separately in a folding box. The folding boxes are packed in cardboard boxes.